

FB-EM-30349-000  
SHT 1.1

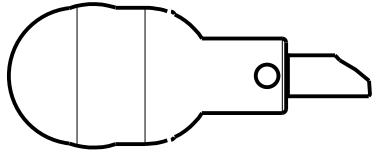

TOP VIEW  
W/WINDSHIELD SHOWN  
SCALE 1:1

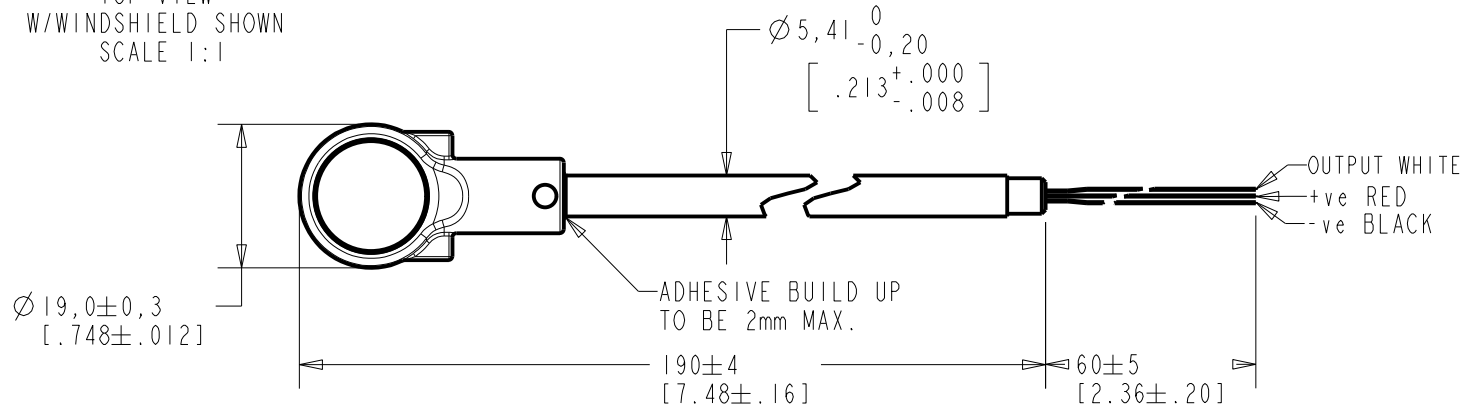

PLASTIC HOUSING, BLACK

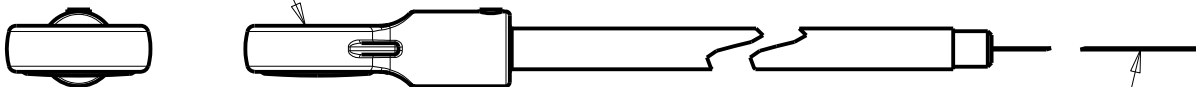

WIRES  
2mm STRIPPED & TINNED ENDS

| WIRE COLOR |        |       | WEIGHT GRAMS |
|------------|--------|-------|--------------|
| +ve        | OUTPUT | -ve   |              |
| RED        | WHITE  | BLACK | ---          |

DIMENSIONS IN MILLIMETERS [INCHES]

| Revision | C.O. #    | Implementation Date | RELEASE LEVEL | REVISION |
|----------|-----------|---------------------|---------------|----------|
| C        | C40100518 | 11-23-10            | Active        | C        |
| B        | C10107748 | 8-12-08             |               |          |
| A        | C10107379 | 6-26-08             |               |          |

**KNOWLES ELECTRONICS**  
ITASCA, ILLINOIS U.S.A.

|  |             |              |
|--|-------------|--------------|
| SCALE: 1:1                             | DR. BY TT   | DATE 6-26-08 |
| DO NOT SCALE DRAWING                   | CK. BY GJP  | DATE 7-15-08 |
| TITLE: BOOM MICROPHONE FB-EM-30349-000 | APP. BY GJP | DATE 7-15-08 |
| OUTLINE DRAWING                        | SHT 1.1     |              |

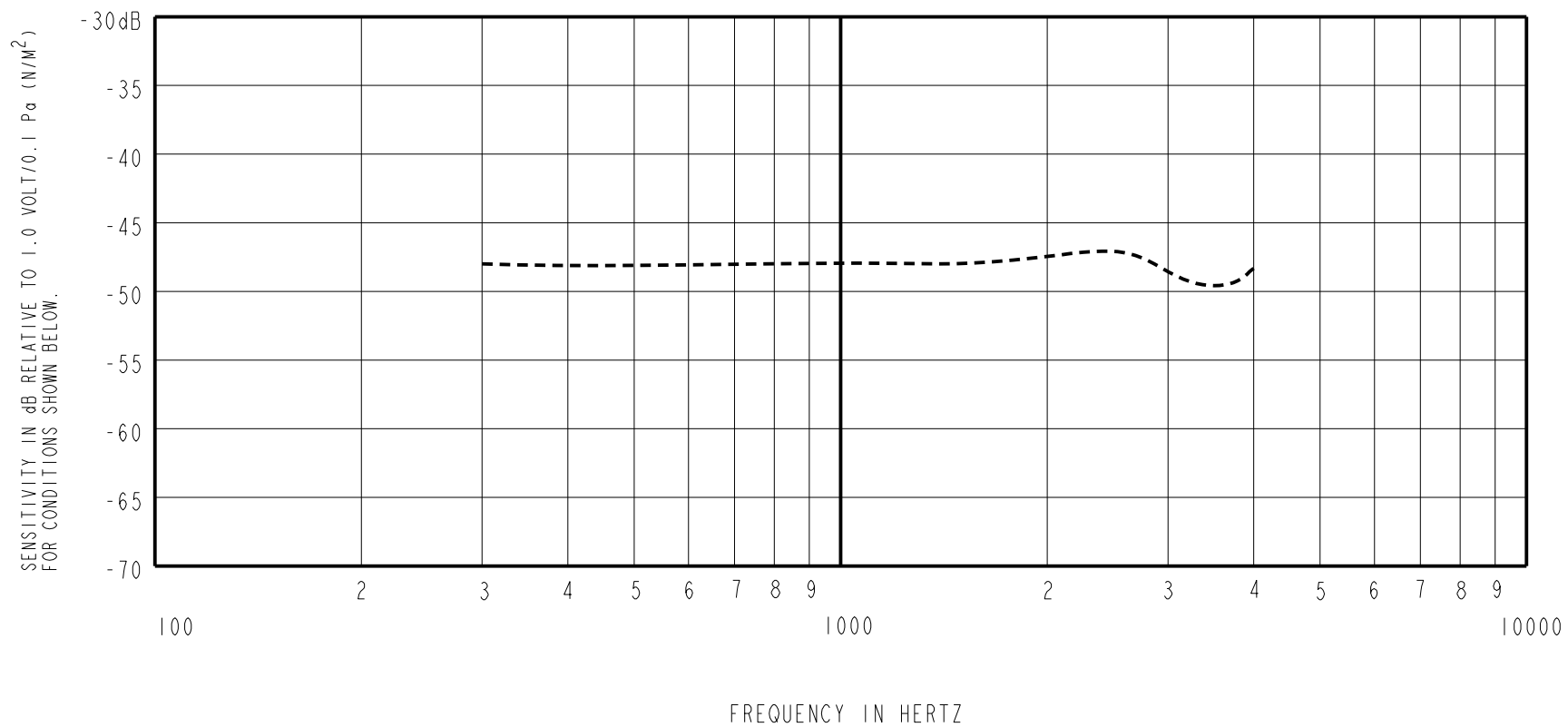

| FREQUENCY | SENSITIVITY |       |       | DEVICE CONFORMITY            |      |
|-----------|-------------|-------|-------|------------------------------|------|
|           | MIN.        | NOM.  | MAX.  | RANGE OF DEVIATION FROM 1KHz |      |
| 300       | ---         | -48.0 | ---   | -3.0                         | +3.0 |
| 1000      | -51.0       | -48.0 | -45.0 | 0.0                          | 0.0  |
| 4000      | ---         | -47.0 | ---   | -3.0                         | +5.0 |

NOTES:

- MICROPHONE TO BE FUNCTIONAL WITH 10 VDC SUPPLY.
- SENSITIVITY VALUES INDICATED ON THIS SPECIFICATION ARE VALID AT 50% HUMIDITY.
- TEST CONDITIONS:  
HEAD OF BOOM EXPOSED TO 74 dB SPL SWEPT SOUND FIELD AT 6mm FROM VOICE APERTURE.  
ARTIFICIAL VOICE:  
B & k 4227 MOUTH SIMULATOR.
- FOR MICROPHONE CAPSULE SPEC. SEE DRAWING EK-23132-C36 SHEET 2.1.
- SURVIVES 20m SUBMERSION BASED ON QUALIFICATION TESTING. 100% TEST 30 MINUTES 1m SUBMERSION; SENSITIVITY WITHIN 3dB OF INITIAL SENSITIVITY AFTER DRIED FOR 30 MINUTES AT ROOM TEMPERATURE.

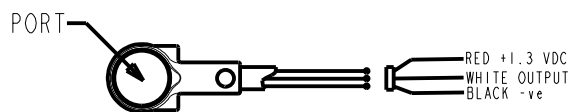
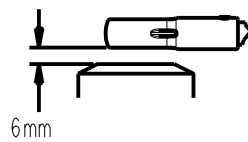

LEAD IDENTIFICATION  
& TEST CIRCUIT

| Revision | C.O. #    | Implementation Date | RELEASE LEVEL | REVISION |
|----------|-----------|---------------------|---------------|----------|
| C        | C40100518 | 11-23-10            | <b>Active</b> | <b>C</b> |
| B        | C10107748 | 8-12-08             |               |          |
| A        | C10107379 | 6-26-08             |               |          |

**KNOWLES ELECTRONICS**  
ITASCA, ILLINOIS U.S.A.

WHEN TEST LIMITS ARE USED TO ESTABLISH INCOMING INSPECTION ACCEPTANCE/REJECTION CRITERIA, CORRELATION OF TEST EQUIPMENT WITH KNOWLES IS ALSO REQUIRED FOR ELIMINATION OF EQUIPMENT AND TEST METHOD VARIATION

TITLE: **BOOM MICROPHONE FB-EM-30349-000**  
PERFORMANCE SPECIFICATION **SHT 2.1**

| DR. BY  | DATE    |
|---------|---------|
| TT      | 6-26-08 |
| CK. BY  | DATE    |
| GJP     | 7-15-08 |
| APP. BY | DATE    |
| GJP     | 7-15-08 |