

TRANSDUCER SIGNAL PORT LOCATION KEY

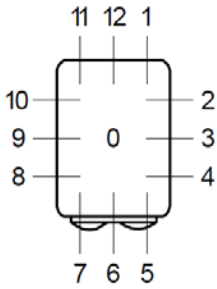

The Signal Port Location Key compares the transducer case to a clock face and identifies the signal port locations with the hour hand positions of that clock. A tubed acoustic port is implied unless otherwise specified.

The transducer case consists of two parts, a bottom cup with terminals mounted to it and a top cover. If the transducer is viewed looking down at the cover with the middle of the terminal board at 6 o'clock, the signal port locations are as shown as pictured. The "0" position is at the center of the clock dial.

When combined with the below listed "Port Detail Codes", this forms the alpha-numeric Signal Port Location nomenclature, e.g., 12B port, 3S port, OKP port, etc., used throughout the Knowles transducer data sheets.

THE FOLLOWING LETTER CODES ARE DEFINED FOR ADDITIONAL INFORMATION ON PORT LOCATION:

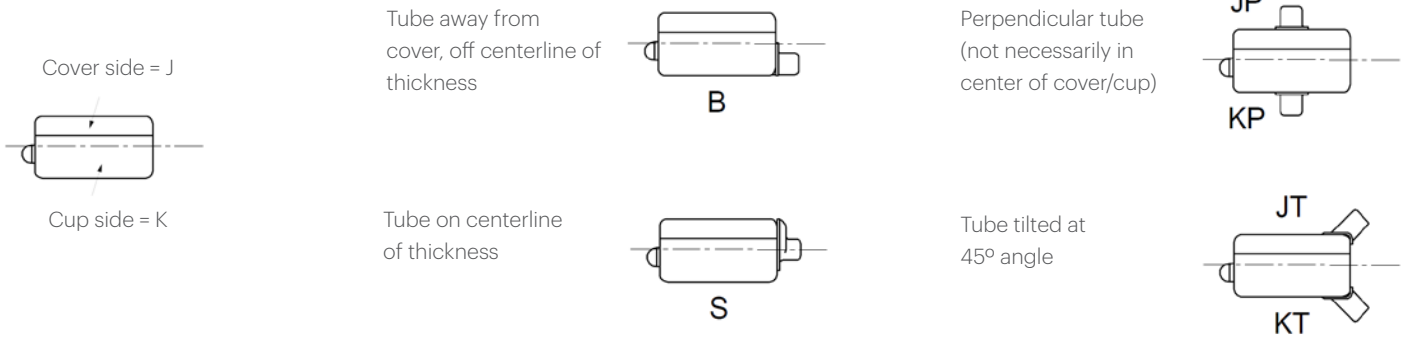

PORT DETAIL CODES

a = "Salt shaker" port (multiple small openings in cup or cover)	P = Tube perpendicular to large surface of cup or cover
B = Tube away from cover	S = Tube on centerline
C = Tube near cover	T = Tube tilted 45° from cup or cover
L = Large diameter tube	y = Port with special location
m = Microtube	
n = No tube	

DIRECTIONAL MICROPHONES:

1st code is for front port, 2nd code is for rear port.

EXCEPTIONS:

Products which do not follow the standard Transducer Signal Port Location nomenclature are addressed on an individual basis.



SIGNAL PORT LOCATION EXAMPLES



TO microphone
with 12S port

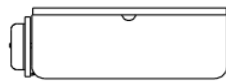

TO microphone
with 12n port

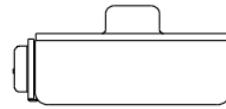

TO microphone
with OJP port

Transducers in the same family can have a variety of signal port locations, sizes, and styles.

Transducers in different families can have the same signal port location and style.

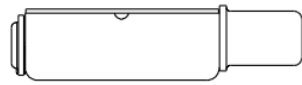

TO microphone
with 12S port



RAB receiver
with 12S port



RAD receiver
with 12S port

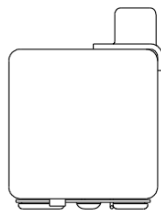

TO microphone with 11C ports

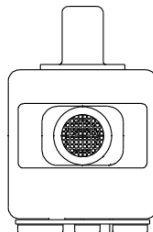
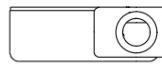

TD microphone with 12C/12KP ports

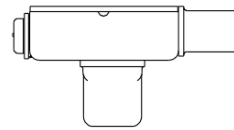

Special port locations, styles, and sizes are also available for many transducer series.

Exceptions: Some model series do not follow the above port description precisely due to their varied construction

Port labels apply to cylindrical-shaped transducers.

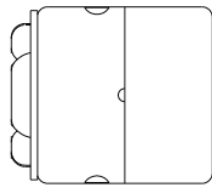

FG Microphone with 12N port

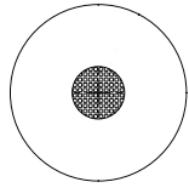

Signal port location for MEMS microphone

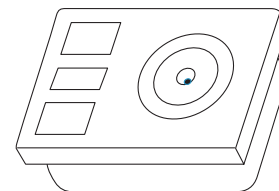

MM15 Microphone with 12JPN port

Drawings on this page are not to scale